



CITY OF ST. PETERSBURG, FLORIDA

PLANNING AND DEVELOPMENT SERVICES DEPARTMENT

URBAN PLANNING AND HISTORIC PRESERVATION DIVISION

STAFF REPORT

Community Planning and Preservation Commission Certificate of Appropriateness Request

Report to the Community Planning and Preservation Commission from the Urban Planning and Historic Preservation Division, Planning and Development Services Department, for Public Hearing and Executive Action scheduled for **Tuesday, August 9, 2022, beginning at 2:00 p.m.**, in Council Chambers of City Hall, 175 Fifth St. N., St. Petersburg, Florida. Everyone is encouraged to view the meetings on TV or online at www.stpete.org/meetings.

According to Planning & Development Services Department records, no Commission member or his or her spouse has a direct or indirect ownership interest in real property located within 2,000 linear feet of real property contained with the application (measured in a straight line between the nearest points on the property lines). All other possible conflicts should be declared upon the announcement of the item.



2022 Photograph via Realtor.com

Case No.:	22-90200082
Address:	3624 Dr. ML King Jr St N
Legal Description:	ALLENDALE TERRACE BLK B, LOTS 22 AND 22 SEE N 12-31-16
Parcel ID No.:	07-31-17-00522-008-0220
Date of Construction:	Circa 1928
Local Landmark:	Almon Jones-Jay Black House (HPC 04-03)
Request:	Request for the approval of a Certificate of Appropriateness for the installation of a front fence and associated gates and driveway

Historical Context and Significance

The Almon Jones-Jay Black House at 3624 Dr. ML King Jr St N ("the subject property") was designed by local builder Cade Allen and constructed circa 1928. It is located within the Allendale neighborhood, which comprises the city's largest collection of his eclectic designs. It features the unique brand of masonry, Mediterranean-influenced architecture that Cade Alen is known for. The subject property was designated as a local historic landmark in 2004.

Project Description and Review

Project Description

The application (Appendix A) proposes the following:

- A 4 foot perimeter fence. Please note that, while the original application suggests a 5 foot fence, the applicant has changed the proposal to 4 feet via subsequent correspondence with staff (see attachment to application, Appendix A). The fence will include the following features:
 - Iron or aluminum fence panels with "Classic" style vertical panels and
 - Stuccoed masonry columns with terracotta caps

General Criteria for Granting Certificates of Appropriateness and Staff Findings

1. *The effect of the proposed work on the landmark or the property upon which such work is to be done.*

Generally consistent

Unlike other applications for front fences reviewed by this Commission in recent memory, the subject property is designated as an individual local historic landmark, and not as a contributing resource to a local historic district.

As such, the impact on the individual building be reviewed herein, and the effect on the surrounding streetscape is less important than it would be in a local historic district.

The proposed fence features a fairly high degree of transparency and references the design of the residence in its style. It will not obscure the public view of the landmark.

The site plan included in the application shows that the fence will be set back from the sidewalk. This setback is an important tool to decrease any negative impact that a fence may have on a pedestrian experience. Staff recommends that this setback be approximately 3 feet from the sidewalk's edge.

2. *The relationship between such work and other structures on the landmark site or other property in the historic district.*

Consistent Staff generally recommends that front fences within the boundaries of local historic landmarks (be they individually listed or districts), be kept at about 3 feet in height. In this case, staff understands the applicant's request for a taller fence of 4 feet due to safety concerns along a busy road. The sensitive design and high transparency of the proposed fence help mitigate the added height.

3. *The extent to which the historic, architectural, or archaeological significance, architectural style, design, arrangement, texture and materials of the local landmark or the property will be affected.*

Consistent The fence will not directly impact the designated building.

4. *Whether the denial of a Certificate of Appropriateness would deprive the property owner of reasonable beneficial use of his or her property.*

Consistent The applicant notes safety concerns due to the subject property's location on Dr. ML King Jr St N. This street is designated as a Future Major Street by Map 20 of the City's Comprehensive Plan.

5. *Whether the plans may be reasonably carried out by the applicant.*

Consistent The proposed project appears to be appropriate under this criterion.

6. *A COA for a noncontributing structure in a historic district shall be reviewed to determine whether the proposed work would negatively impact a contributing structure or the historic integrity of the district. Approval of a COA shall include any conditions necessary to mitigate or eliminate negative impacts.*

Not applicable The subject property is a local historic landmark.

Summary of Findings, Certificate of Appropriateness Review

Staff evaluation yields a finding of the following criteria being met by the proposed project:

- General Criteria for Granting Certificates of Appropriateness: 5 of 5 relevant criteria fully or partially satisfied.

Staff Recommendation

Based on a determination of general consistency with Chapter 16, City Code of Ordinances, staff recommends that the Community Planning and Preservation Commission **approve** the Certificate of Appropriateness request for the installation of a fence at the Almon Jones-Jay Black House at 3624 Dr ML King Jr St N, with the following conditions:

1. Panels be no more than 4 feet in height, when measured from grade.
2. Columns be no more than 4.5 feet in height, when measured from grade.
3. Gate design be approved by staff for compatibility with the subject property's architectural style prior to installation.
4. The fence panels be no less than 3 feet from the sidewalk edge.
5. A historic preservation final inspection will be required.

6. All other necessary permits shall be obtained. The fence is to comply with all Zoning requirements. Any additional work shall be presented to staff for determination of the necessity of additional COA approval.
7. This approval will be valid for 24 months, for an expiration date of August 9, 2024

Report Prepared By:



08.05.2022

Laura Duvekot, Historic Preservationist II
Urban Planning and Historic Preservation Division
Planning and Development Services Department

Date

Report Approved By:



08.05.2022

Derek S. Kilborn, Manager
Urban Planning and Historic Preservation Division
Planning and Development Services Department

Date

Appendix A:

Application No. 22-90200082



CERTIFICATE OF APPROPRIATENESS

APPLICATION

All applications are to be filled out completely and correctly. The application shall be submitted to the City of St. Petersburg's Planning and Development Services Department, located on the 8th floor of the Municipal Services Building, One Fourth Street North, St. Petersburg, Florida. Laura Duvekot, Historic Preservationist II, (727) 892-5451 or Laura.Duvekot@stpete.org

GENERAL INFORMATION

Property Address	Parcel Identification No.
Historic District / Landmark Name	Corresponding Permit Nos.
Owner's Name	Property Owner's Daytime Phone No.
Owner's Address, City, State, Zip Code	Owner's Email
Authorized Representative (Name & Title), if applicable	Representative's Daytime Phone No.
Representative's Address, City, State, Zip Code	Representative's Email

APPLICATION TYPE (Check applicable)		TYPE OF WORK (Check applicable)	
<input type="checkbox"/>	Addition	<input type="checkbox"/>	Window Replacement
<input type="checkbox"/>	New Construction	<input type="checkbox"/>	Door Replacement
<input type="checkbox"/>	Demolition	<input type="checkbox"/>	Roof Replacement
<input type="checkbox"/>	Relocation	<input type="checkbox"/>	Mechanical (e.g. solar)
<input type="checkbox"/>	Other:	<input type="checkbox"/>	Repair Only
		<input type="checkbox"/>	In-Kind Replacement
		<input type="checkbox"/>	New Installation
		<input type="checkbox"/>	Other:

AUTHORIZATION

By signing this application, the applicant affirms that all information contained within this application packet has been read and that the information on this application represents an accurate description of the proposed work. The applicant certifies that the project described in this application, as detailed by the plans and specifications enclosed, will be constructed in exact accordance with aforesaid plans and specifications. Further, the applicant agrees to conform to all conditions of approval. It is understood that approval of this application by the Community Planning and Preservation Commission in no way constitutes approval of a building permit or other required City permit approvals. Filing an application does not guarantee approval.

- NOTES:** 1) It is incumbent upon the applicant to submit correct information. Any misleading, deceptive, incomplete or incorrect information may invalidate your approval.
- 2) To accept an agent's signature, a notarized letter of authorization from the property owner must accompany the application.

Signature of Owner: _____ Date: _____

Signature of Representative: _____ Date: _____



COA #

PROPOSED SCOPE OF WORK

Building or Site Feature	Photo No.	Proposed Work

**OLIVER RESIDENCE
3624 DR. MLK JR., N.
ST. PETERSBURG, FL.**

AS PER THE ATTACHED PLAN DATED 6/6/22, SITE AMENITIES AS FOLLOWS:

.....

REAR LANDSCAPE SCREENING TO INCLUDE ;

- 3 - FOXTAIL PALM “TRIPLES”
- 5 - ARECA PALMS

SIDE-REAR YARD SCREENING;

- 4 - SKYROCKET JUNIPERS
- 4 - TRAVELETRS PALMS

MASONRY COLUMNS-ALUMINUM FENCING & HEDGE;

- 11 - 4.5' x 2.0' x 2.0' WHITE STUCCO COLUMNS WITH TERRA COTTA CONCRETE CAP
 TO MATCH RESIDENCE WITH BLACK ALUMINUM RAILING/FENCE & GATES.
 (1 DRIVEWAY GATE AND 1 ENTRY WALK GATE.)
- 30 - PODOCARPUS MAKI HEDGE

DRIVEWAY AND WALK;

CONSTRUCTED OUT OF PERVIOUS AND PERMEABLE, ECO-SENSITIVE HARDSCAPE
;PAVERS BY 'TREMOR'.



PRICE CATALOG

2022 Version 2.5

A few details about this catalog, product info & getting a quote...

This price catalog has all of our in-stock items and prices listed throughout. We also offer custom styles and services if there is something you don't see in the catalog. Email us at: sales@ironfenceshop.com to inquire about your custom project.

If you are looking for more information about our products or installation, you can visit our YouTube channel by typing "Iron Fence Shop" into the search bar at www.youtube.com.

You can also visit our Knowledge Center on www.ironfenceshop.com to view our installation manuals, installed project photos, CAD renderings of all panels and gates and spec sheets along with lots of other helpful information including our blog. To find the Knowledge Center, just look for 'Knowledge Center' at the top of the homepage and you'll see a dropdown menu.

While you can use this catalog for per part pricing; we like to speak to each person about their project. Once you are ready to get a quote or order, send us a layout sketch or materials list and we will put together an itemized quote for you detailing all the parts required and shipping cost. Sending us a simple layout sketch is the best way for us to make sure your order is 100% accurate!

If you have any questions about our prices, products or process; feel free to call us at 800-261-2729 or send an email to sales@ironfenceshop.com. We are here to help!



Table of Contents

Stronghold Iron®..... PG5

Classic Style Fence..... PG5

Fence Panels..... PG5

Transition Fence Panels..... PG5

Single Gates..... PG5

Arched Gates..... PG5

Double Gates..... PG6

Pool Style Fence..... PG6

Fence Panels..... PG6

Single Gates..... PG6

Double Gates..... PG6

Puppy Picket Style Fence..... PG7

Fence Panels..... PG7

Single and Double Gates..... PG7

Hoop and Picket Style Fence..... PG7

Fence Panels..... PG7

Single and Double Gates..... PG7

Classic Style Driveway Gates..... PG8

Single Gates..... PG8

Double Gates..... PG8

Smooth Top Style Driveway Gates..... PG9

Double Gates..... PG9

Rings Puppy Picket Style Driveway Gates..... PG9

Double Gates..... PG9

Fence and Gate Posts..... PG10

Standard Iron Posts..... PG10

Iron Flange Posts..... PG10

Iron Driveway Gate Posts..... PG10

Iron Fence and Gate Hardware..... PG11

Iron Post Caps..... PG11

Iron Brackets..... PG11

Iron Screws..... PG11

Infinity Aluminum®.....	PG.12
<u>Classic Style Fence.....</u>	PG.12
Fence Panels.....	PG.12
Single Gates.....	PG.12
Arched Gates.....	PG.12
Double Gates.....	PG.13
<u>Pool Style Fence.....</u>	PG.13
Fence Panels.....	PG.13
Single Gates.....	PG.13
Double Gates.....	PG.13
<u>Classic Style Driveway Gates.....</u>	PG.14
Single Gates.....	PG.14
Double Gates.....	PG.14
<u>Smooth Top Style Driveway Gates.....</u>	PG.14
Double Gates.....	PG.14
<u>Fence and Gate Posts.....</u>	PG.15
Standard Iron Posts.....	PG.15
Iron Flange Posts.....	PG.16
Iron Driveway Gate Posts.....	PG.16
<u>Aluminum Fence and Gate Hardware.....</u>	PG.17
Aluminum Post Caps.....	PG.17
Aluminum Post Flanges.....	PG.17
Aluminum Brackets.....	PG.17
Aluminum Screws.....	PG.17
Aluminum Post Flanges.....	PG.17
<u>Gate Hinge and Latch Hardware.....</u>	PG.18
Hinges.....	PG.18
Latches.....	PG.18
Drop Rods.....	PG.18
<u>Driveway Gate Automation.....</u>	PG.19
Opener Systems.....	PG.19
Transmitters.....	PG.19
Keypads and Intercoms.....	PG.19
Locks.....	PG.19
Entry/ Exit Sensors.....	PG.19
Power Accessories.....	PG.19
<u>Add-On Decorations.....</u>	PG.20
Individual Decorations.....	PG.20
Decorations by the Panel.....	PG.20

Stronghold Iron®

* Iron fence prices do not include brackets and self-tapping screws required for mounting (see Iron Hardware section)

* Iron walk gate prices do not include hinge and latch hardware (see Gate Hardware section)

Classic Style Iron Fence

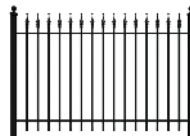

Traditional Grade Fence Panels

Size	SKU	Price
3'h x 8'w	TP0308-2R	\$227.44
4'h x 8'w	TP0408-2R	\$244.15
5'h x 8'w	TP0508-2R	\$280.93
6'h x 8'w	TP0608-3R	\$354.52

Signature Grade Fence Panels

Size	SKU	Price
3'h x 8'w	TP0308-2C	\$341.14
4'h x 8'w	TP0408-2C	\$357.87
5'h x 8'w	TP0508-2C	\$377.94
6'h x 8'w	TP0608-3C	\$498.74

Signature

4' to 5' Arch	TPGW448	\$344.14
5' to 6' Arch	TPGW548	\$448.87

Traditional Grade Single Gates

Size	SKU	Price
3'h x 4'w	TP0304-RG	\$387.96
3'h x 5'w	TP0305-RG	\$401.34
4'h x 4'w	TP0404-RG	\$401.34
4'h x 5'w	TP0405-RG	\$441.47
4'h x 6'w	TP0406-RG	\$508.37
5'h x 4'w	TP0504-RG	\$461.55
5'h x 5'w	TP0505-RG	\$494.99
5'h x 6'w	TP0506-RG	\$575.25
6'h x 4'w	TP0604-RG	\$521.76
6'h x 5'w	TP0605-RG	\$615.39
6'h x 6'w	TP0606-RG	\$715.73

Signature Grade Single Gates

Size	SKU	Price
3'h x 4'w	TP0304-CG	\$531.19
3'h x 5'w	TP0305-CG	\$535.11
4'h x 4'w	TP0404-CG	\$561.88
4'h x 5'w	TP0405-CG	\$628.77
4'h x 6'w	TP0406-CG	\$749.17
5'h x 4'w	TP0504-CG	\$648.83
5'h x 5'w	TP0505-CG	\$735.78
5'h x 6'w	TP0506-CG	\$882.94
6'h x 4'w	TP0604-CG	\$782.62
6'h x 5'w	TP0605-CG	\$896.32
6'h x 6'w	TP0606-CG	\$996.66

Traditional Grade Arched Gates

Size	SKU	Price
3'h x 4'w	TP0304-RGA	\$607.99
4'h x 4'w	TP0404-RGA	\$621.37
5'h x 4'w	TP0504-RGA	\$681.58
6'h x 4'w	TP0604-RGA	\$741.77

Signature Grade Arched Gates

Size	SKU	Price
3'h x 4'w	TP0304-CGA	\$751.21
4'h x 4'w	TP0404-CGA	\$781.92
5'h x 4'w	TP0504-CGA	\$868.87
6'h x 4'w	TP0604-CGA	\$1,002.64



Classic Style Iron Fence (cont'd)

Traditional Grade Double Gates

<u>Size</u>	<u>SKU</u>	<u>Price</u>
3'h x 8'w	TP0304-RGD	\$775.93
3'h x 10'w	TP0305-RGD	\$802.68
4'h x 8'w	TP0404-RGD	\$802.68
4'h x 10'w	TP0405-RGD	\$882.94
4'h x 12'w	TP0406-RGD	\$1,016.73
5'h x 8'w	TP0504-RGD	\$923.08
5'h x 10'w	TP0505-RGD	\$989.97
5'h x 12'w	TP0506-RGD	\$1,150.51
6'h x 8'w	TP0604-RGD	\$1,043.48
6'h x 10'w	TP0605-RGD	\$1,230.78
6'h x 12'w	TP0606-RGD	\$1,431.45

Signature Grade Double Gates

<u>Size</u>	<u>SKU</u>	<u>Price</u>
3'h x 8'w	TP0304-CGD	\$1,062.35
3'h x 10'w	TP0305-CGD	\$1,070.24
4'h x 8'w	TP0404-CGD	\$1,123.76
4'h x 10'w	TP0405-CGD	\$1,257.53
4'h x 12'w	TP0406-CGD	\$1,498.34
5'h x 8'w	TP0504-CGD	\$1,297.66
5'h x 10'w	TP0505-CGD	\$1,471.57
5'h x 12'w	TP0506-CGD	\$1,765.89
6'h x 8'w	TP0604-CGD	\$1,565.22
6'h x 10'w	TP0605-CGD	\$1,792.65
6'h x 12'w	TP0606-CGD	\$1,993.31

Pool Style Iron Fence

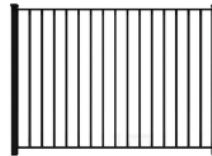

Traditional Grade Fence Panels

<u>Size</u>	<u>SKU</u>	<u>Price</u>
50"h x 8'w	TP5008-2R	\$212.51

Signature Grade Fence Panels

<u>Size</u>	<u>SKU</u>	<u>Price</u>
50"h x 8'w	TP5008-2C	\$311.51

Traditional Grade Single Gates

<u>Size</u>	<u>SKU</u>	<u>Price</u>
50"h x 4'w	TP5004-RG	\$494.99

Signature Grade Single Gates

<u>Size</u>	<u>SKU</u>	<u>Price</u>
50"h x 4'w	TP5004-CG	\$588.63

Traditional Grade Double Gates

<u>Size</u>	<u>SKU</u>	<u>Price</u>
50"h x 8'w	TP5004-RGD	\$989.97

Signature Grade Double Gates

<u>Size</u>	<u>SKU</u>	<u>Price</u>
50"h x 8'w	TP5004-CGD	\$1,177.27



Puppy Picket Style Iron Fence

Traditional Grade Fence Panels

<u>Size</u>	<u>SKU</u>	<u>Price</u>
4'h x 8'w	TP0408PPR	\$311.17
5'h x 8'w	TP0508PPR	\$357.01

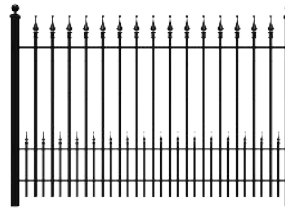

Traditional Grade Single Gates

<u>Size</u>	<u>SKU</u>	<u>Price</u>
4'h x 4'w	TPG44PPR	\$633.68
4'h x 5'w	TPG45PPR	\$704.10
5'h x 4'w	TPG54PPR	\$739.30
5'h x 5'w	TPG55PPR	\$809.72

Traditional Grade Double Gates

<u>Size</u>	<u>SKU</u>	<u>Price</u>
4'h x 8'w	TPG44PPRD	\$1,267.38
4'h x 10'w	TPG45PPRD	\$1,408.20
5'h x 8'w	TPG54PPRD	\$1,478.61
5'h x 10'w	TPG55PPRD	\$1,619.43

Hoop and Picket Style Iron Fence

Traditional Grade Fence Panels

<u>Size</u>	<u>SKU</u>	<u>Price</u>
3'h x 8'w	TP0308HP	\$255.92
4'h x 8'w	TP0408HP	\$274.65

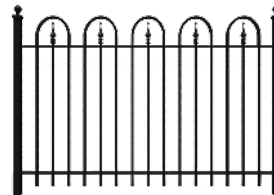

Traditional Grade Single Gates

<u>Size</u>	<u>SKU</u>	<u>Price</u>
3'h x 4'w	TP0304HPG	\$424.34
3'h x 5'w	TP0305HPG	\$437.71
4'h x 4'w	TP0404HPG	\$437.71
4'h x 5'w	TP0405HPG	\$477.85

Traditional Grade Double Gates

<u>Size</u>	<u>SKU</u>	<u>Price</u>
3'h x 8'w	TP0304HPGD	\$848.68
3'h x 10'w	TP0305HPGD	\$875.41
4'h x 8'w	TP0404HPGD	\$875.41
4'h x 10'w	TP0405HPGD	\$955.67

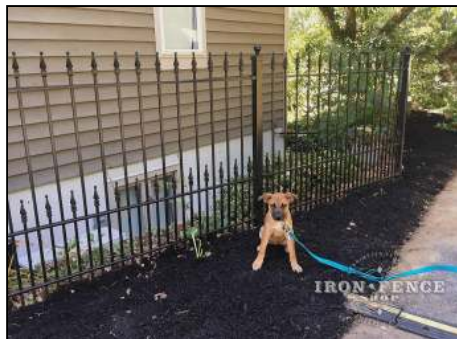

Classic Style Iron Driveway Gates

* Driveway gate prices do not include hinges and latches required for mounting (see Gate Hardware section for options)

* Optional automated gate opener systems available (see Gate Automation section for options)

Single Piece Gates

Height	Width	SKU	Price
5' to 6' Arch	10' wide	TPSD5610	\$2,044.03
5' to 6' Arch	12' wide	TPSD5612	\$2,679.41
6' to 7' Arch	10' wide	TPSD6710	\$2,194.97
6' to 7' Arch	12' wide	TPSD6712	\$2,830.35



Double Piece Gates

Height	Width	SKU	Price
5' to 6' Arch	10' wide	TPDD0565	\$1,871.53
5' to 6' Arch	12' wide	TPDD0566	\$1,931.91
5' to 6' Arch	14' wide	TPDD0567	\$2,233.77
5' to 6' Arch	16' wide	TPDD0568	\$2,505.45
5' to 6' Arch	18' wide	TPDD0569	\$2,837.49
5' to 6' Arch	20' wide	TPDD5610	\$3,109.17
6' to 7' Arch	10' wide	TPDD0675	\$2,022.47
6' to 7' Arch	12' wide	TPDD0676	\$2,082.85
6' to 7' Arch	14' wide	TPDD0677	\$2,414.89
6' to 7' Arch	16' wide	TPDD0678	\$2,777.12
6' to 7' Arch	18' wide	TPDD0679	\$3,109.17
6' to 7' Arch	20' wide	TPDD6710	\$3,471.40



Smooth Top Style Iron Driveway Gates

* Driveway gate prices do not include hinges and latches required for mounting (see Gate Hardware section for options)

* Optional automated gate opener systems available (see Gate Automation section for options)

Double Piece Gates

<u>Height</u>	<u>Width</u>	<u>SKU</u>	<u>Price</u>
5' to 6' Arch	12' wide	TPDD0566SM	\$1,931.91
5' to 6' Arch	14' wide	TPDD0567SM	\$2,233.77
5' to 6' Arch	16' wide	TPDD0568SM	\$2,505.45
6' to 7' Arch	12' wide	TPDD0676SM	\$2,082.85
6' to 7' Arch	14' wide	TPDD0677SM	\$2,414.89
6' to 7' Arch	16' wide	TPDD0678SM	\$2,777.12



Rings Puppy Picket Style Iron Driveway Gates

* Driveway gate prices do not include hinges and latches required for mounting (see Gate Hardware section for options)

* Optional automated gate opener systems available (see Gate Automation section for options)

Double Piece Gates

<u>Height</u>	<u>Width</u>	<u>SKU</u>	<u>Price</u>
6' to 7' Arch	12' wide	TPDD676DPR	\$3,026.62
6' to 7' Arch	14' wide	TPDD677DPR	\$3,413.04
6' to 7' Arch	16' wide	TPDD678DPR	\$3,894.74

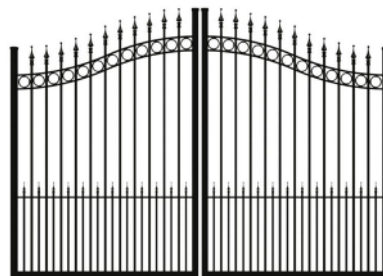

Stronghold Iron Fence and Gate Posts

* Post prices do not include post cap (see Iron Hardware section for options)

Standard Posts

<u>Size</u>	<u>Length</u>	<u>Thickness</u>	<u>SKU</u>	<u>Price</u>
2" x 2"	5'	14ga	TP2205	\$45.13
2" x 2"	6'	14ga	TP2206	\$49.34
2" x 2"	7'	14ga	TP2207	\$58.51
2" x 2"	8'	14ga	TP2208	\$64.38
2" x 2"	9'	14ga	TP2209	\$84.43
2.5" x 2.5"	6'	14ga	TP252506	\$60.21
2.5" x 2.5"	7'	14ga	TP252507	\$73.59
2.5" x 2.5"	8'	14ga	TP252508	\$88.61
2.5" x 2.5"	9'	14ga	TP252509	\$98.65
3" x 3"	5'	14ga	TP3305	\$70.24
3" x 3"	6'	14ga	TP3306	\$81.09
3" x 3"	7'	14ga	TP3307	\$97.00
3" x 3"	8'	14ga	TP3308	\$111.18
3" x 3"	9'	14ga	TP3309	\$121.22
4" x 4"	7'	14ga	TP44714	\$164.69
4" x 4"	8'	14ga	TP44814	\$175.57
4" x 4"	9'	14ga	TP44914	\$200.66

Flange Posts

<u>Size</u>	<u>Length</u>	<u>Thickness</u>	<u>SKU</u>	<u>Price</u>
2.5" x 2.5"	3'	14ga	TPPFL253	\$50.17
2.5" x 2.5"	4'	14ga	TPPFL254	\$55.17
2.5" x 2.5"	5'	14ga	TPPFL255	\$66.90
2.5" x 2.5"	6'	14ga	TPPFL256	\$78.57

Driveway Gate Posts

<u>Size</u>	<u>Length</u>	<u>Thickness</u>	<u>SKU</u>	<u>Price</u>
4" x 4"	8'	7ga	TP4408	\$334.44
4" x 4"	9'	7ga	TP4409	\$367.90
6" x 6"	8'	7ga	TP6608	\$518.41
6" x 6"	9'	7ga	TP6609	\$551.84
6" x 6"	10'	7ga	TP6610	\$628.42

Stronghold Iron Fence and Gate Hardware

* Two brackets and self-tapping screws required per horizontal rail
(2 rail fence panel = 4 brackets and screws)

Cast Iron Flat Post Caps

<u>Size</u>	<u>SKU</u>	<u>Price</u>
2"	TP06004BH	\$5.22
2.5"	TP06010BH	\$5.61
3"	TP06005BH	\$6.95
4"	TP06006BH	\$10.75
6"	TP06007BH	\$19.45

Cast Iron Ball Post Caps

<u>Size</u>	<u>SKU</u>	<u>Price</u>
2"	TP05009BH	\$6.95
2.5"	TP05010BH	\$10.75
3"	TP05011BH	\$13.24
4"	TP05012BH	\$25.54
6"	TP05014BH	\$52.36

Traditional Grade Panel Brackets

<u>Type</u>	<u>SKU</u>	<u>Price</u>
Standard	TPFB01R	\$2.40
Angle	TPFBA05R	\$4.47

Signature Grade Panel Brackets

<u>Type</u>	<u>SKU</u>	<u>Price</u>
Standard	TPFB02C	\$2.65
Angle	TPFBA06C	\$5.22

Self-Tapping Screws (100 per Box)

<u>Size</u>	<u>SKU</u>	<u>Price</u>
1" x #14	TPSDS114	\$19.45



Infinity Aluminum®

* Aluminum fence requires use of self-tapping screws for installation (see Aluminum Hardware section)

* Aluminum walk gate prices do not include hinge and latch hardware (see Gate Hardware section for options)

Classic Style Aluminum Fence

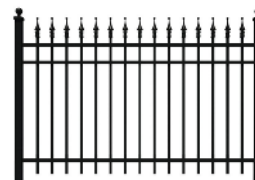

Traditional Grade Fence Panels

<u>Size</u>	<u>SKU</u>	<u>Price</u>
3'h x 6'w	TPA0306R	\$167.59
4'h x 6'w	TPA0406R	\$175.79
5'h x 6'w	TPA0506R	\$218.47
6'h x 6'w	TPA0606R	\$264.80

Signature Grade Fence Panels

<u>Size</u>	<u>SKU</u>	<u>Price</u>
3'h x 6'w	TPA0308C-6	\$239.40
3'h x 8'w	TPA0308C	\$305.23
4'h x 6'w	TPA0408C-6	\$254.37
4'h x 8'w	TPA0408C	\$323.20

Signature

5'h x 6'w	TPA0508C-6	\$269.32
6'h x 6'w	TPA0608C-6	\$344.14

Traditional Grade Single Gates

<u>Size</u>	<u>SKU</u>	<u>Price</u>
3'h x 4'w	TPAG0304R	\$440.06
3'h x 5'w	TPAG0305R	\$523.69
4'h x 4'w	TPAG0404R	\$466.83
4'h x 5'w	TPAG0405R	\$553.61
4'h x 6'w	TPAG0406R	\$703.23
5'h x 4'w	TPAG0504R	\$526.68
5'h x 5'w	TPAG0505R	\$628.42
5'h x 6'w	TPAG0506R	\$748.11
6'h x 4'w	TPAG0604R	\$586.53
6'h x 5'w	TPAG0605R	\$703.23
6'h x 6'w	TPAG0606R	\$792.99

Signature Grade Single Gates

<u>Size</u>	<u>SKU</u>	<u>Price</u>
3'h x 4'w	TPAG0304C	\$591.45
3'h x 5'w	TPAG0305C	\$710.69
4'h x 4'w	TPAG0404C	\$628.42
4'h x 5'w	TPAG0405C	\$748.11
4'h x 6'w	TPAG0406C	\$867.80
5'h x 4'w	TPAG0504C	\$748.11
5'h x 5'w	TPAG0505C	\$867.80
5'h x 6'w	TPAG0506C	\$987.49
6'h x 4'w	TPAG0604C	\$807.96
6'h x 5'w	TPAG0605C	\$927.66
6'h x 6'w	TPAG0606C	\$1,047.35

Traditional Grade Arched Gates

<u>Size</u>	<u>SKU</u>	<u>Price</u>
3'h x 4'w	TPAG0304R-A	\$660.10
4'h x 4'w	TPAG0404R-A	\$686.87
5'h x 4'w	TPAG0504R-A	\$746.71
6'h x 4'w	TPAG0604R-A	\$806.55

Signature Grade Arched Gates

<u>Size</u>	<u>SKU</u>	<u>Price</u>
3'h x 4'w	TPAG0304C-A	\$848.44
4'h x 4'w	TPAG0404C-A	\$864.44
5'h x 4'w	TPAG0504C-A	\$968.14
6'h x 4'w	TPAG0604C-A	\$1,027.99



Classic Style Aluminum Fence (cont'd)

Traditional Grade Double Gates

<u>Size</u>	<u>SKU</u>	<u>Price</u>
3'h x 8'w	TPAG0304RD	\$880.13
3'h x 10'w	TPAG0305RD	\$1,047.35
4'h x 8'w	TPAG0404RD	\$933.65
4'h x 10'w	TPAG0405RD	\$1,107.20
4'h x 12'w	TPAG0406RD	\$1,406.44
5'h x 8'w	TPAG0504RD	\$1,053.34
5'h x 10'w	TPAG0505RD	\$1,256.81
5'h x 12'w	TPAG0506RD	\$1,496.21
6'h x 8'w	TPAG0604RD	\$1,173.05
6'h x 10'w	TPAG0605RD	\$1,406.44
6'h x 12'w	TPAG0606RD	\$1,585.98

Signature Grade Double Gates

<u>Size</u>	<u>SKU</u>	<u>Price</u>
3'h x 8'w	TPAG0304CD	\$1,182.88
3'h x 10'w	TPAG0305CD	\$1,421.39
4'h x 8'w	TPAG0404CD	\$1,256.81
4'h x 10'w	TPAG0405CD	\$1,496.21
4'h x 12'w	TPAG0406CD	\$1,735.61
5'h x 8'w	TPAG0504CD	\$1,496.21
5'h x 10'w	TPAG0505CD	\$1,735.61
5'h x 12'w	TPAG0506CD	\$1,975.00
6'h x 8'w	TPAG0604CD	\$1,615.91
6'h x 10'w	TPAG0605CD	\$1,855.30
6'h x 12'w	TPAG0606CD	\$2,094.69

Pool Style Aluminum Fence



Traditional Grade Fence Panels

<u>Size</u>	<u>SKU</u>	<u>Price</u>
54"h x 6'w	TPA5406R	\$191.52

Signature Grade Fence Panels

<u>Size</u>	<u>SKU</u>	<u>Price</u>
54"h x 8'w	TPA5408C	\$329.18

Traditional Grade Single Gates

<u>Size</u>	<u>SKU</u>	<u>Price</u>
54"h x 4'w	TPAG0544R	\$496.75
54"h x 5'w	TPAG0545R	\$598.48
54"h x 6'w	TPAG0546R	\$718.19

Signature Grade Single Gates

<u>Size</u>	<u>SKU</u>	<u>Price</u>
54"h x 4'w	TPAG0544C	\$628.42
54"h x 5'w	TPAG0545C	\$748.11
54"h x 6'w	TPAG0546C	\$867.80

Traditional Grade Arched Gates

<u>Size</u>	<u>SKU</u>	<u>Price</u>
54"h x 4'w	TPAG0544R-A	\$716.78

Signature Grade Arched Gates

<u>Size</u>	<u>SKU</u>	<u>Price</u>
54"h x 4'w	TPAG0544C-A	\$848.44

Traditional Grade Double Gates

<u>Size</u>	<u>SKU</u>	<u>Price</u>
54"h x 8'w	TPAG0544RD	\$993.49
54"h x 10'w	TPAG0545RD	\$1,196.97
54"h x 12'w	TPAG0546RD	\$1,436.37

Signature Grade Double Gates

<u>Size</u>	<u>SKU</u>	<u>Price</u>
54"h x 8'w	TPAG0544CD	\$1,256.81
54"h x 10'w	TPAG0545CD	\$1,496.21
54"h x 12'w	TPAG0546CD	\$1,735.61

Classic Style Aluminum Driveway Gates

* Driveway gate prices do not include hinges and latches required for mounting (see Gate Hardware section for options)

* Optional automated gate opener systems available (see Gate Automation section for options)

Single Piece Gates

Height	Width	SKU	Price
5' to 6' Arch	10' wide	TPSD5610A	\$2,044.03
5' to 6' Arch	12' wide	TPSD5612A	\$2,679.41
6' to 7' Arch	10' wide	TPSD6710A	\$2,194.97
6' to 7' Arch	12' wide	TPSD6712A	\$2,830.35

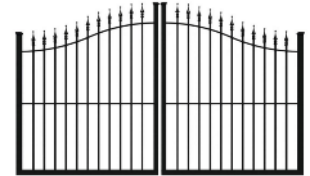

Double Piece Gates

Height	Width	SKU	Price
5' to 6' Arch	10' wide	TPDD0565A	\$1,871.53
5' to 6' Arch	12' wide	TPDD0566A	\$1,931.91
5' to 6' Arch	14' wide	TPDD0567A	\$2,233.77
5' to 6' Arch	16' wide	TPDD0568A	\$2,505.45
5' to 6' Arch	18' wide	TPDD0569A	\$2,837.49
5' to 6' Arch	20' wide	TPDD5610A	\$3,109.17
6' to 7' Arch	10' wide	TPDD0675A	\$2,022.47
6' to 7' Arch	12' wide	TPDD0676A	\$2,082.85
6' to 7' Arch	14' wide	TPDD0677A	\$2,414.89
6' to 7' Arch	16' wide	TPDD0678A	\$2,777.12
6' to 7' Arch	18' wide	TPDD0679A	\$3,109.17
6' to 7' Arch	20' wide	TPDD6710A	\$3,471.40

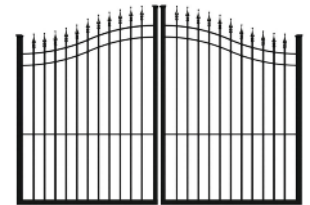

Smooth Top Style Aluminum Driveway Gates

* Driveway gate prices do not include hinges and latches required for mounting (see Gate Hardware section for options)

* Optional automated gate opener systems available (see Gaet Automation section for options)

Double Piece Gates

Height	Width	SKU	Price
5' to 6' Arch	12' wide	TPDD0566ASM	\$1,931.91
5' to 6' Arch	14' wide	TPDD0567ASM	\$2,233.77
5' to 6' Arch	16' wide	TPDD0568ASM	\$2,505.45
6' to 7' Arch	12' wide	TPDD0676ASM	\$2,082.85
6' to 7' Arch	14' wide	TPDD0677ASM	\$2,414.89
6' to 7' Arch	16' wide	TPDD0678ASM	\$2,777.12

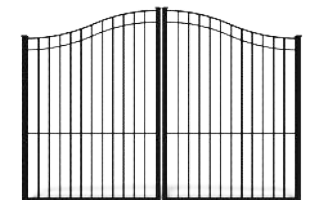

Infinity Aluminum Fence and Gate Posts

* Post prices do not include post cap (see Aluminum Hardware section for options)

Traditional Grade Posts

<u>Fence</u>	<u>SKU</u>	<u>Post Size</u>	<u>Length</u>	<u>Thickness</u>	<u>Type</u>	<u>Price</u>
3ft Tall	TPAP3606LR	2" x 2"	5'	0.060"	Line	\$44.90
3ft Tall	TPAP3606ER	2" x 2"	5'	0.060"	End	\$44.90
3ft Tall	TPAP3606CR	2" x 2"	5'	0.060"	Corner	\$44.90
3ft Tall	TPAP3612ER	2" x 2"	5'	0.125"	Gate End	\$73.29
3ft Tall	TPAP3612R	2" x 2"	5'	0.125"	Blank	\$110.72
4ft Tall	TPAP4606LR	2" x 2"	6'	0.060"	Line	\$47.89
4ft Tall	TPAP4606ER	2" x 2"	6'	0.060"	End	\$47.89
4ft Tall	TPAP4606CR	2" x 2"	6'	0.060"	Corner	\$47.89
4ft Tall	TPAP4612ER	2" x 2"	6'	0.125"	Gate End	\$77.82
4ft Tall	TPAP4612R	2" x 2"	6'	0.125"	Blank	\$110.72
54" Tall	TPAP5406LR	2" x 2"	6.5'	0.060"	Line	\$52.36
54" Tall	TPAP5406ER	2" x 2"	6.5'	0.060"	End	\$52.36
54" Tall	TPAP5406CR	2" x 2"	6.5'	0.060"	Corner	\$52.36
54" Tall	TPAP5412ER	2" x 2"	6.5'	0.125"	Gate End	\$85.26
54" Tall	TPAP5412R	2" x 2"	6.5'	0.125"	Blank	\$110.72
5ft Tall	TPAP5606LR	2" x 2"	7'	0.060"	Line	\$56.87
5ft Tall	TPAP5606ER	2" x 2"	7'	0.060"	End	\$56.87
5ft Tall	TPAP5606CR	2" x 2"	7'	0.060"	Corner	\$56.87
5ft Tall	TPAP5612ER	2" x 2"	7'	0.125"	Gate End	\$91.25
5ft Tall	TPAP5612R	2" x 2"	7'	0.125"	Blank	\$110.72
6ft Tall	TPAP6606LR	2" x 2"	8.5'	0.060"	Line	\$68.84
6ft Tall	TPAP6606ER	2" x 2"	8.5'	0.060"	End	\$68.84
6ft Tall	TPAP6606CR	2" x 2"	8.5'	0.060"	Corner	\$68.84
6ft Tall	TPAP6612ER	2" x 2"	8.5'	0.125"	Gate End	\$110.72
6ft Tall	TPAP6612R	2" x 2"	8.5'	0.125"	Blank	\$110.72

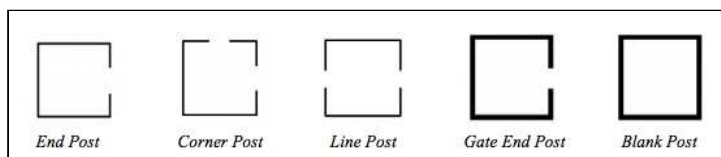

Aluminum Fence and Gate Posts (cont'd)

Signature Grade Posts

<u>Fence</u>	<u>SKU</u>	<u>Post Size</u>	<u>Length</u>	<u>Thickness</u>	<u>Type</u>	<u>Price</u>
3ft Tall	TPAP3807LC	2.5" x 2.5"	5'	0.070"	Line	\$61.34
3ft Tall	TPAP3807EC	2.5" x 2.5"	5'	0.070"	End	\$61.34
3ft Tall	TPAP3807CC	2.5" x 2.5"	5'	0.070"	Corner	\$61.34
3ft Tall	TPAP3812EC	2.5" x 2.5"	5'	0.125"	Gate End	\$109.22
3ft Tall	TPAP3812C	2.5" x 2.5"	5'	0.125"	Blank	\$149.63
4ft Tall	TPAP4807LC	2.5" x 2.5"	6'	0.070"	Line	\$65.85
4ft Tall	TPAP4807EC	2.5" x 2.5"	6'	0.070"	End	\$65.85
4ft Tall	TPAP4807CC	2.5" x 2.5"	6'	0.070"	Corner	\$65.85
4ft Tall	TPAP4812EC	2.5" x 2.5"	6'	0.125"	Gate End	\$116.71
4ft Tall	TPAP4812C	2.5" x 2.5"	6'	0.125"	Blank	\$149.63
54" Tall	TPAP5407LC	2.5" x 2.5"	6.5'	0.070"	Line	\$77.82
54" Tall	TPAP5407EC	2.5" x 2.5"	6.5'	0.070"	End	\$77.82
54" Tall	TPAP5407CC	2.5" x 2.5"	6.5'	0.070"	Corner	\$77.82
54" Tall	TPAP5412EC	2.5" x 2.5"	6.5'	0.125"	Gate End	\$130.16
54" Tall	TPAP5412C	2.5" x 2.5"	6.5'	0.125"	Blank	\$149.63
5ft Tall	TPAP5807LC	2.5" x 2.5"	7'	0.070"	Line	\$79.28
5ft Tall	TPAP5807EC	2.5" x 2.5"	7'	0.070"	End	\$79.28
5ft Tall	TPAP5807CC	2.5" x 2.5"	7'	0.070"	Corner	\$79.28
5ft Tall	TPAP5812EC	2.5" x 2.5"	7'	0.125"	Gate End	\$131.66
5ft Tall	TPAP5812C	2.5" x 2.5"	7'	0.125"	Blank	\$149.63
6ft Tall	TPAP6807LC	2.5" x 2.5"	8.5'	0.070"	Line	\$94.24
6ft Tall	TPAP6807EC	2.5" x 2.5"	8.5'	0.070"	End	\$94.24
6ft Tall	TPAP6807CC	2.5" x 2.5"	8.5'	0.070"	Corner	\$94.24
6ft Tall	TPAP6812EC	2.5" x 2.5"	8.5'	0.125"	Gate End	\$149.63
6ft Tall	TPAP6812C	2.5" x 2.5"	8.5'	0.125"	Blank	\$149.63

Driveway Gate Posts

<u>Size</u>	<u>Length</u>	<u>Thickness</u>	<u>SKU</u>	<u>Price</u>
4" x 4"	8'	0.125"	TP4408A	\$284.28
4" x 4"	9'	0.125"	TP4409A	\$335.34
6" x 6"	9'	0.125"	TP6609A	\$586.85

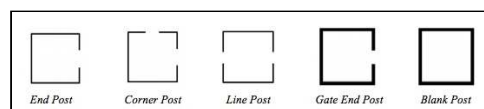

Infinity Aluminum Fence and Gate Hardware

Cast Aluminum Flat Post Caps

<u>Size</u>	<u>SKU</u>	<u>Price</u>
2"	TP06004-BHA	\$5.22
2.5"	TP06010-BHA	\$5.99
4"	TP06006-ALBH	\$22.48
6"	TP06007-ALBH	\$35.91

Cast Aluminum Ball Post Caps

<u>Size</u>	<u>SKU</u>	<u>Price</u>
2"	TP05009-BHA	\$10.47
2.5"	TP05010-BHA	\$11.97
4"	TP05012-ALBH	\$44.90
6"	TP05014-ALBH	\$59.85

Traditional Grade Panel Brackets

<u>Type</u>	<u>SKU</u>	<u>Price</u>
Wall/ Flex	TPAFBRR1	\$5.99
Angle	TPAFBAR2	\$5.99
Swivel	NW61955BKR	\$10.88

Signature Grade Panel Brackets

<u>Type</u>	<u>SKU</u>	<u>Price</u>
Wall/ Flex	TPAFBRC3	\$8.99
Angle	TPAFBRC4	\$8.99
Swivel	NW6228BKC	\$10.88

Self-Tapping Screws (100 per Box)

<u>Size</u>	<u>SKU</u>	<u>Price</u>
1" x #8	TPSDS108	\$11.97

Flange Inserts for Posts

<u>Size</u>	<u>SKU</u>	<u>Price</u>
2"	TP12208B	\$17.97
2.5"	TP12209B	\$17.97



Gate Hinge and Latch Hardware

Gate Hinges

<u>Type</u>	<u>Description</u>	<u>Adjustable?</u>	<u>Rating</u>	<u>SKU</u>	<u>Price</u>
J-Bolt	5.5" J-Bolt	Yes	300lbs	TPJB55 (ea)	\$25.65
J-Bolt	7" J-Bolt	Yes	450lbs	TPJB07 (ea)	\$41.37
J-Bolt	Hdw Kit	N/A	N/A	TPHBOLTS (1 per hinge pr)	\$24.47
Self-Closing	Standard- Duty	No	66lbs	TPSHG-90L (pr)	\$36.88
Self-Closing	Heavy-Duty	No	154lbs	TPSHH-135LS (pr)	\$68.13

Gate Latches

<u>Description</u>	<u>Handle?</u>	<u>Keyed?</u>	<u>SKU</u>	<u>Price</u>
Standard Gravity Latch	No	No	TP11056B	\$11.51
Cobra Single Gravity Latch	No	Yes	TPSL1000	\$44.25
Cobra Double Gravity Latch	No	Yes	TPSL2000	\$95.32
Safetech Pool Latch	No	Yes	TPSL-50	\$69.37
OrnaMag Latch	Yes	Yes	TP-OM_BL-K	\$87.45

Drop Rods for Double Gates

<u>Size</u>	<u>SKU</u>	<u>Price</u>
24" Standard	TP09010-1B	\$29.92
36" Standard	TP9010B	\$37.39

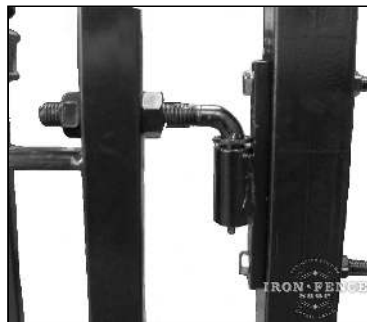

Driveway Gate Automation

Opener Systems

	SKU	Price
Linear PRO Single Gate Opener Kit (Medium Duty)	TPSW3000XLS	\$1,075.25
Linear PRO Slave Motor for 3000 Series	TPSW3200XLS	\$683.10
Linear PRO Single Gate Opener Kit (Heavy Duty)	TPSW4000XLS	\$1,564.75
Linear PRO Slave Motor for 4000 Series	TPSW4200XLS	\$1,067.28
Linear PRO Push to Open Bracket for 3000 Series	TPR4388	\$68.63

Transmitters

Linear PRO 2-Button Transmitter	TPRB742	\$44.61
Linear PRO 1-Button Transmitter	TPRB741	\$33.89
Linear PRO Push Button Doorbell Style Opener	TPRB101	\$11.55

Keypads and Intercoms

Linear PRO Bulldog Pedestrian Gate Lock and Keypad	TPFM145	\$451.61
Linear PRO Wired/ Wireless Intercom with Keypad	TPF3100MBC	\$500.94
Linear PRO Addl Intercom Base for TPFM3100MBC	TPF3101MBC	\$253.95
Linear PRO Wired/ Wireless Keypad	TPF310	\$115.44
Linear PRO Gooseneck Post for Keypad/ Intercom	TPF100	\$223.00

Locks

Linear PRO Pin Lock	TPFM345	\$26.93
Linear PRO Electric Gate Lock	TPFM144	\$196.06

Entry/ Exit Sensors

Linear PRO Vehicle Exit Sensor (50')	TPFM139	\$230.64
Linear PRO Wireless Vehicle Exit Sensor	TPR4500	\$338.71
Linear PRO Photoelectric Dual Beam Detector	TPR4222	\$202.34
Linear PRO Siren Operated Sensor (SOS)	TPSOS2510373	\$910.80

Power Accessories

Linear PRO 10W Solar Panel Kit	TPFM123	\$284.57
Linear PRO Replacement/ Additional Battery	TPRB500	\$61.58
Linear PRO Replacement Plug-In Transformer	TPRB570	\$38.48

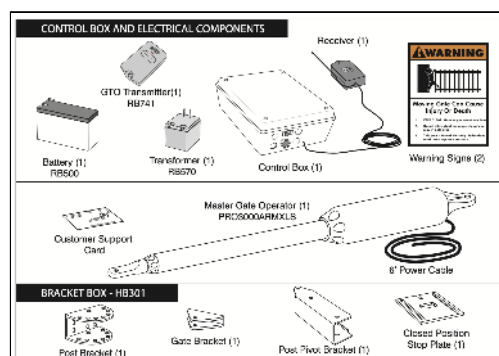

Add-On Decorations

* All add-on decorations fit vertically over the picket and are secured via self-tapping screws

Individual Decorations

<u>Fence Grade</u>	<u>Style</u>	<u>SKU</u>	<u>Price</u>	<u>Height</u>	<u>Width</u>
Traditional	Butterfly	TP12010-BH	\$3.00	3.625"	3.75"
Signature	Butterfly	TP12010-2BH	\$3.00	3.625"	3.75"
Traditional	Ring Set	TPDRA01R	\$8.99	3.75"	12.875"
Signature	Ring Set	TPDRA02C	\$8.99	3.75"	12.875"
Traditional	Guardian	TP12001-BH	\$22.40	16.5"	6.75"
Signature	Guardian	TP12001-2BH	\$22.40	16.5"	6.75"
Traditional	Cape Cod	TP12004-BH	\$22.40	13.75"	7.25"
Signature	Cape Cod	TP12004-2BH	\$22.40	13.75"	7.25"
Traditional	Oak	TP12002-BH	\$26.77	15.125"	7.875"
Signature	Oak	TP12002-2BH	\$26.77	15.125"	7.875"

Self-Tapping Screws for Decorations

<u>Size</u>	<u>SKU</u>	<u>Price</u>	<u>Count</u>	<u>Note</u>
1/2" x #8	TPSDS058	\$16.76	100/ Box	For Ring Decorations Only
3/4" x #8	TPSDS348	\$16.76	100/ Box	For All Decorations Except Rings
1" x #8	TPSDS108P	\$16.76	100/ Box	For Signature Butterflies



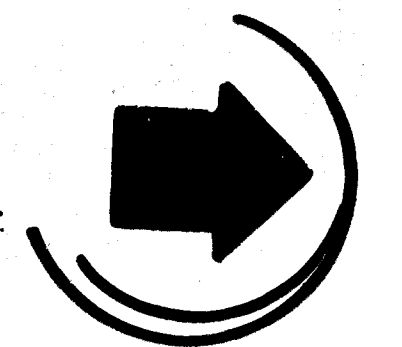
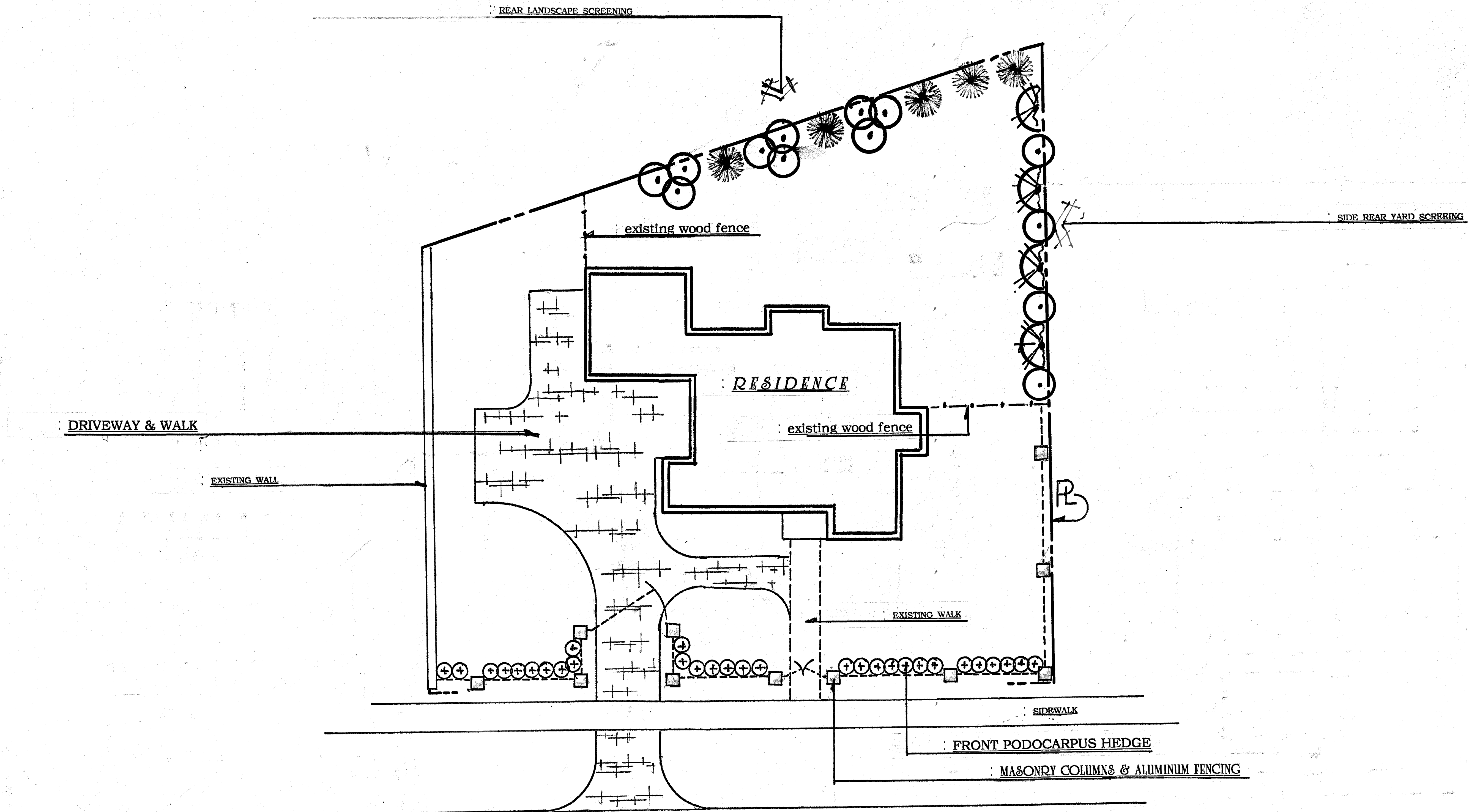

W. OLIVER		3624 DR. MLK JR. N. ST. PETERSBURG, FL.	
SCALE: 1" = 10'-0"	APPROVED BY:	DRAWN BY: MEM	REVISED:
DATE: 6-4-88			
GULF COAST MAINT. & L/S			
L/S LAYOUT PLAN			DRAWING NUMBER

Laura Duvekot

From: William Oliver <wo@hb-m.com>
Sent: Friday, June 17, 2022 2:20 PM
To: Laura Duvekot
Subject: COA supporting documents...
Attachments: price_book_2022_v2.5.pdf; scanOliver.pdf; OLIVER SIGTE AMENITIES.doc

Follow Up Flag: Follow up
Flag Status: Completed

CAUTION: This email originated from outside of the organization. Do not click links or open attachments unless you recognize the sender and know the content is safe.

Laura,

Here are the details we discussed for our perimeter fence COA application.

Fence:

I am attaching the brochure for the fence we will be purchasing. It is titled "Classic Style Iron Fence" (Page 5) If the iron fence is not available within a 3 month timeline for delivery we will use the same style, but with an aluminum substrate (Page 12). Fence height we are requesting is 4'. I know we discussed 3' as possible, but I am requesting 4' as the result of our proximity to Dr MLK street which is a busy road at high traffic times. We have dogs, and we are starting a family and the 4' height is requested for both safety, and privacy.

Columns:

Regarding the concrete columns for the driveway gate, and walkway entry gate we will use a concrete block in a 2 x 2' x 4.5' white stucco column with terra cotta concrete cap to match residence.

Gates:

We will purchase the gates to match the fences. As soon as we have information about what fences are approved we will select a gate that mimics the style, and height.

As stated before, our intention is to start a family in this home. We would like to keep our pets & future kids safe, and our private life private therefore due to the proximity to Dr MLK Street we are requesting an approval for a 4' height perimeter fence as per the drawings.

Cheers,

WILL OLIVER



T 727-315-0385
E wo@hb-m.com
A 7205 30th Ave N, Saint Petersburg, FL 33710

Laura Duvekot

From: Laura Duvekot
Sent: Monday, June 6, 2022 2:39 PM
To: 'William Oliver'
Subject: RE: Perimeter fence COA...

Good afternoon –

Thanks for sending the application form.

For a front fence, we'll need a site plan and materials/design of the fence and columns (for e.g. a manufacturer's brochure).

If you've gotten feedback from Engineering already please let us know that, as well, as I'll be working with them to make sure that any approved COA meets other requirements.

I noticed you're proposing a five foot height. We generally recommend three feet at the front of properties, and the highest that I'm aware has ever been approved is four feet.

I'll be on the lookout for the additional materials. Many thanks!

Best regards,

Laura Duvekot
Historic Preservationist II
Urban Planning and Historic Preservation Division
Planning and Development Services Department
City of St. Petersburg, Florida

727.892.5451
laura.duvekot@stpete.org

From: William Oliver <wo@hb-m.com>
Sent: Sunday, June 5, 2022 8:33 AM
To: Laura Duvekot <Laura.Duvekot@stpete.org>
Subject: Perimeter fence COA...

CAUTION: This email originated from outside of the organization. Do not click links or open attachments unless you recognize the sender and know the content is safe.

Laura,

This is the COA for the perimeter fence. I would like to get this in prior to the June 9th deadline. I am finishing up the detailed plans, and materials next week, and will be ready with the exact details in a few weeks.

Would you please let me know if you need anything else?

Cheers,
WILL OLIVER Co-founder



T 727-315-0385

E wo@hb-m.com

A 7205 30th Ave N, Saint Petersburg, FL 33710

Appendix B:

Maps of Subject Property



Community Planning and Preservation Commission

3624 MLK Dr N

AREA TO BE APPROVED,

SHOWN IN



CASE NUMBER

22-90200082



N

SCALE:
1" = 170'

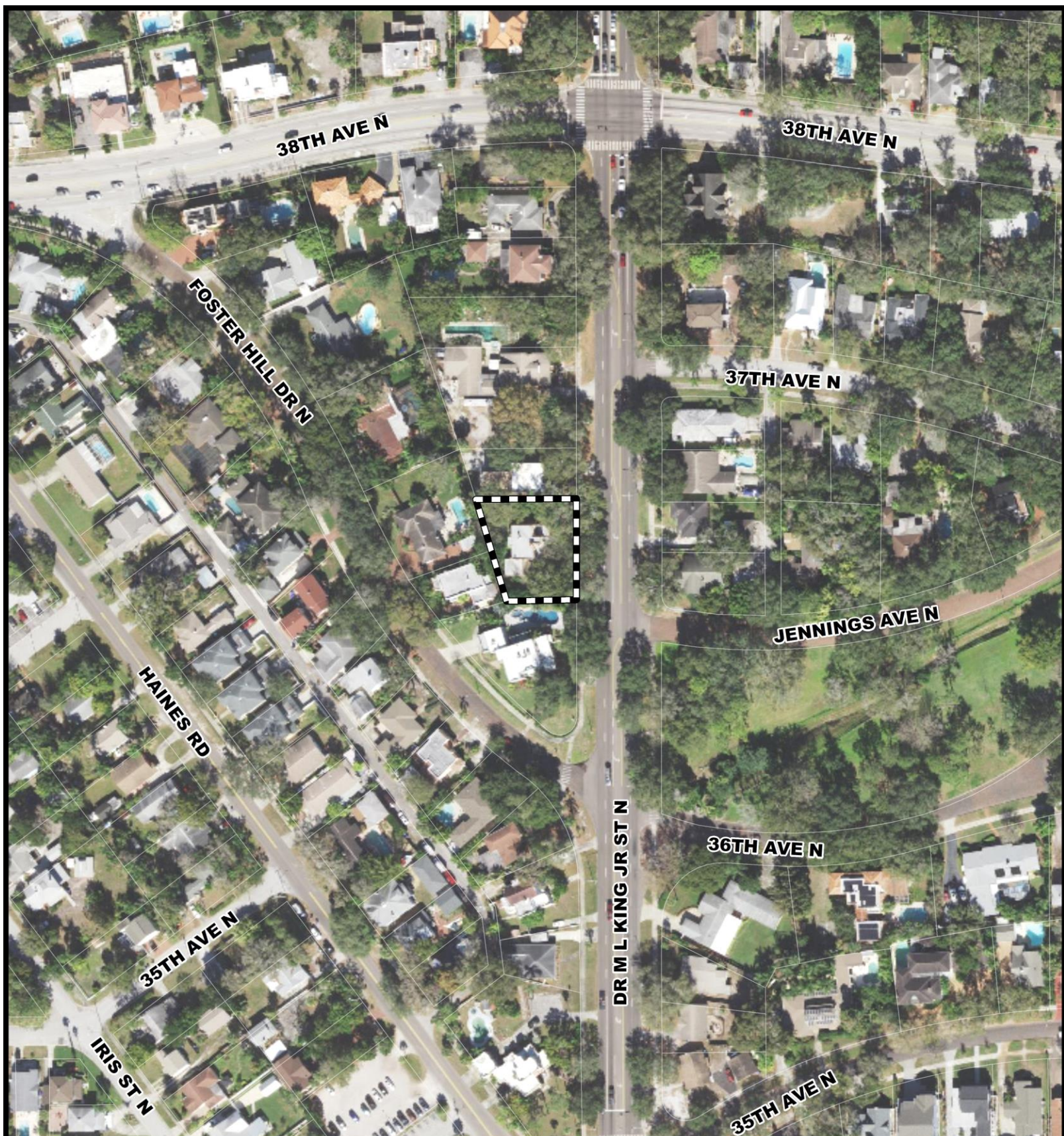

Community Planning and Preservation Commission

3624 MLK Dr N

AREA TO BE APPROVED,

SHOWN IN



CASE NUMBER

22-90200082



SCALE:
1" = 170'